

## 14. Rear Door Trim

### A: REMOVAL

**CAUTION:**

**Do not apply excessive force to the clip. Otherwise the clip may be broken.**

- 1) Disconnect the ground cable from battery.
- 2) Pull the inner remote cover toward you to remove the upper hook. Pull it down to remove the lower hook. Remove the inner remote cover.

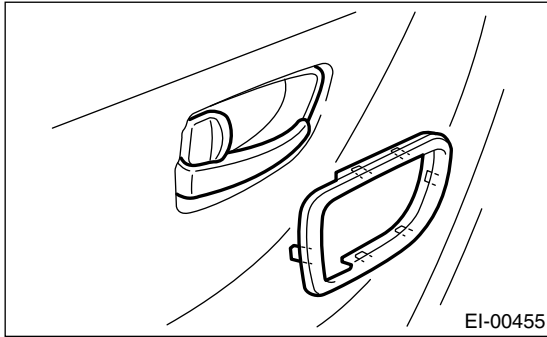

- 3) Remove the screw and clip.

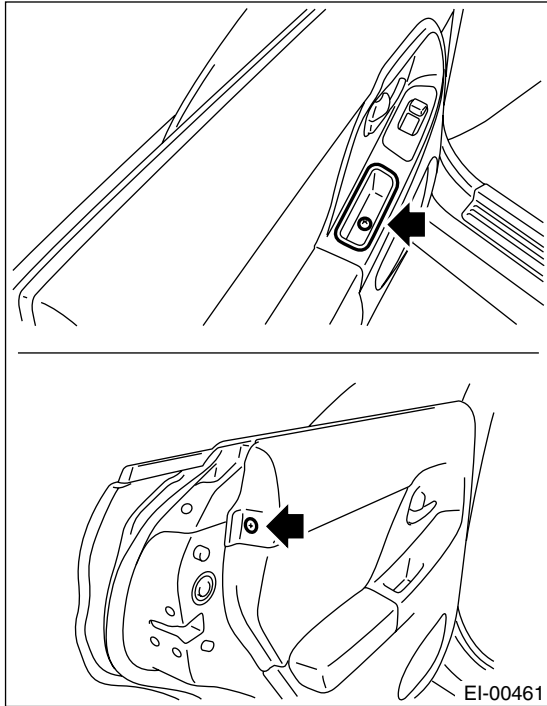

- 4) Remove the clips (A) of trim panel using clip remover to remove the trim panel.

- 5) Disconnect the power window harness connector.

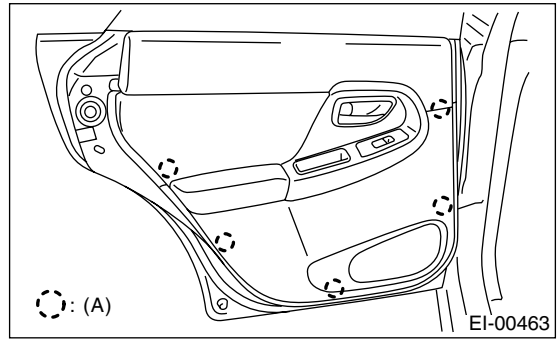

(A) Clip

### B: INSTALLATION

Install in the reverse order of removal.